



BANGI INTERCHANGE TOWARDS SOUTHVILLE EXIT RAMP TEMPORARY CLOSURE FOR TREE FELLING WORKS FROM 25 AUGUST TO 28 AUGUST, 10.00 PM TO 5.00 AM

Petaling Jaya, 22 August 2025:- As part of PLUS Malaysia Berhad (PLUS) continuous efforts to improve safety for highway users, the Bangi Interchange towards Southville Exit Ramp at KM296.5 (Southbound) on the North-South Expressway (NSE) will be temporarily closed in stages from **25 August until 28 August 2025, starting from 10.00 pm until 5.00 am.**

The closure is to facilitate tree felling works using special heavy machineries at the area.

(Please refer to the infographics as attached)

As such, highway users travelling from the Bangi Toll Plaza heading towards Southville or south are advised to utilise an alternative route by using the state road.

Therefore, highway users are encouraged to plan their journeys using the PLUS app to obtain the latest traffic information. They are also advised to adhere to all traffic signs and instructions issued by PLUS personnel when passing through the affected area.

All highway users can also obtain the latest traffic information through the PUTRI Virtual Assistant, X@plustraffic app, and Electronic Signboards (VMS) at selected locations as well as contact PLUSLine at 1800-88-0000 in the event of any emergencies.

-END-

MEDIA CONTACT:

Mashitah Mohd Arshad	Rofina Adam
Acting Head	Manager
Corporate Communications	Corporate Communications
PLUS Malaysia Berhad	PLUS Malaysia Berhad
Mobile: 013-2097092	Mobile: 012-657 4452
Email: mashitah@plus.com.my	Email: rofina@plus.com.my

ATTACHMENT

BANGI INTERCHANGE TOWARDS SOUTHVILLE EXIT RAMP CLOSURE FOR TREE FELLING WORK

Scheduled on 25 August - 28 August 2025
(10.00 pm - 5.00 am)

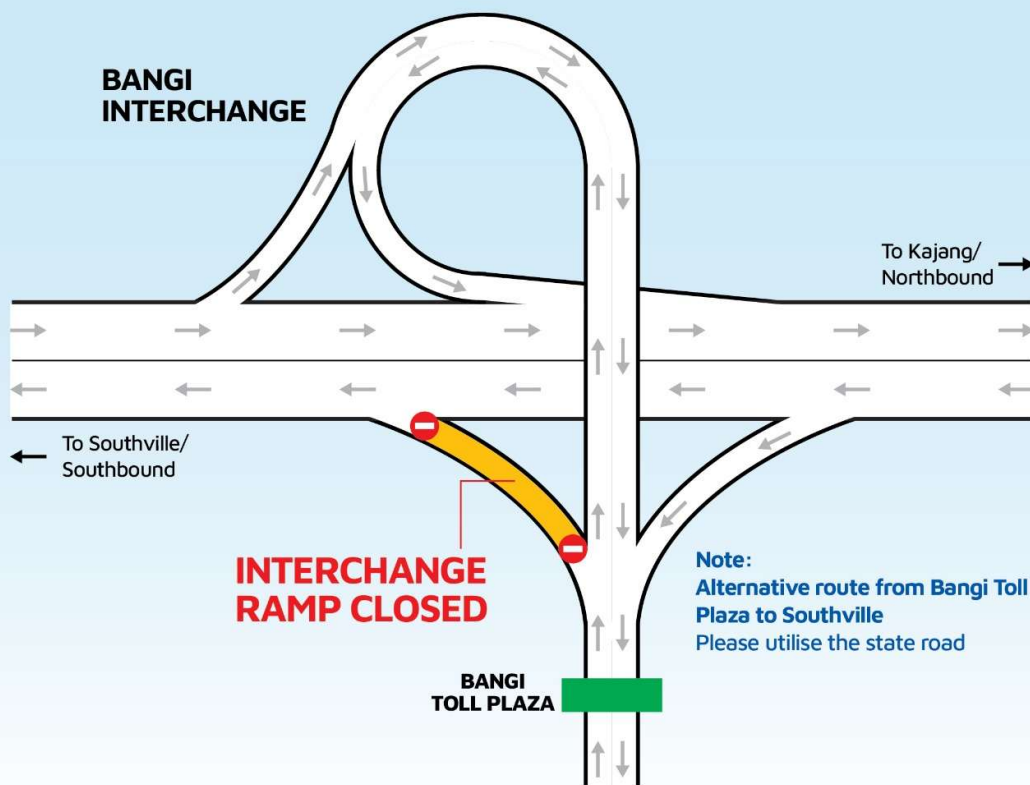

Please obey all traffic signages and instructions when passing through the affected areas.

Follow us on social media



www.plus.com.my

PLUSLine 1800-88-0000

PLUS App

PUTRI



A member of UEM